



Did you know?

Partition walls are purpose built walls for separating rooms on a floor - they are a perfect way to make the most out of your floor space in a building. These walls are fairly easy to construct, lightweight & thin meaning less space is wasted. Generally made from; timber, steel or bricks its purpose can enhance acoustic absorption & reduce thermal bridging.

What you'll need

In order to complete this how to guide, you're going to need the following product:

Isover Acoustic Partition Roll (APR)	British Gypsum Gypframe 'C' Stud
British Gypsum Gypframe Support Channel	British Gypsum Gypframe Floor & Ceiling Channel

OR

We also suggest that you use the following accessories & safety equipment when undertaking this job:

4Trade Safety Glasses	4Trade Super Grip Safety Gloves
4 Trade Respirator Mask	British Gypsum 'Wafer Head' Screw
British Gypsum Jack-Point Screw)	British Gypsum Drywall Screws
Bosch Combi Drill	

Insulating Partition Walls

Pre-Installation

Check that you are installing into a clean, dry environment.

Ventilate the area if possible.

Wear appropriate Personal Protective Equipment (PPE).

Prior to installation it's important to ensure you are installing in a clean, dry environment that is well ventilated. We strongly advise that you use Personal Protective Equipment (PPE) listed above.



Step 1

Ensure the packaging is intact and the roll is not wet or damaged when unwrapping



Step 2

Lay down the partition roll in preparation to cut to the correct size

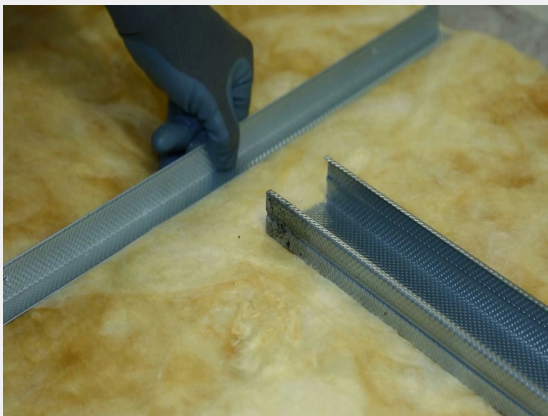

Step 3

Next the APR needs to be cut to size, to do this we recommend using a straight edge & sharp knife.

Remember to leave some extra roll on all edges to avoid gaps during installation



Step 4

Once its cut to size, roll out vertically and align with the timber or steel frame.



Step 5

Ensure the partition roll fully fits into the grooves of the steel or timber frame used. This helps when securing the roll



Step 6

Using a section of steel angle, trap the APR into the edges of the frame - Screw into place to ensure the insulation remains in tact



Step 7

Repeat steps 3 to 6 ensuring each inner section of the steel frame is sufficiently covered with APR



Step 8

Finally, to finish the installation process, ensure there are no gaps - Any that are present need to be filled in order to maintain consistent performance